

Bexley Village Bridge Works update

Work to demolish the bridge at the Old Mill Lane site in Bexley Village and rebuild a stronger and slightly wider one is still on track to finish one month ahead of schedule by the end of June 2016.

Unfortunately the bridge works have been further complicated by the unexpected discovery that a major 30" water main owned by Thames Water is in need of urgent maintenance.

The Thames Water main is not situated within the old bridge structure, it runs parallel to it, and it was therefore not part of the planned works. The state of disrepair only became apparent, when the remaining part of the old bridge was demolished, exposing the main.

As a result of this essential work by Thames Water, Bexley Village High Street (A223) will remain closed at the Old Mill site, until 10 May.

Bexley Village is open for business as usual throughout the bridge closure. In recognition of the impact of the bridge works on the local community, Bexley Village car park charges are not being increased whilst the works are ongoing.

We apologise in advance for any inconvenience caused during these essential water utility maintenance works.

When will the road at the Old Mill site in Bexley Village re-open?

The road will re-open to southbound traffic only on 10 May. Northbound traffic will continue to be diverted via the A2 until the bridge works finish at the end of June 2016.

When will the bridge works finish?

The work will finish one month ahead of schedule at the end of June 2016 when the road at the Old Mill site in Bexley Village will re-open to traffic in both directions.

We apologise for any inconvenience caused during these essential works.

For more information and regular updates on the work visit www.bexley.gov.uk/bexleyhighstreetbridgep2 or email bridges@bexley.gov.uk

Why is there a delay in re-opening the road at the Old Mill site in Bexley Village?

The delay in reopening the road is due to the unexpected discovery that a major 30" water main owned by Thames Water is in need of urgent maintenance.

The Thames Water main is not situated within the old bridge structure, it runs parallel to it, and it was therefore not part of the planned works.

The consequences of Thames Water not carrying out this maintenance could have been severe for the Village. Had the main not been exposed during the bridge works it could have ruptured at any point, potentially flooding the village.

What steps have you taken to minimise the impact of the work?

- Bexley Village is open signs are on display at 12 key access road points.
- We are extending the working hours on site as necessary (7am to 8pm and at weekends).
- The diversion routes via the A2 are well signed and every attempt has been made to prohibit other works happening on these and on other key relief routes.
- We are constructing as much as possible of the new bridge off site
- We are in regular contact with businesses and residents and have regular updates on Twitter and Facebook, in local press and at www.bexley.gov.uk/bexleyhighstreetbridge
- We are using local businesses for supplies where possible. For example Econ Construction Ltd who are based in Ruxley for the demolition, J Clubb in Wilmington for the ready mix concrete and Bexley Sand and Gravel.s
- Signs publicising the road closure are displayed at the bridge site and a variable message sign (VMS) displaying up to date information has been positioned on the Ruxley Corner roundabout. This will give up to date information on congestion and queuing enabling drivers to take alternative routes if necessary.
- Bexley Village car park charges are not being increased whilst the works are ongoing.



LONDON BOROUGH OF
BEXLEY

What impact will the road closure have?

- Traffic will be diverted via the A2. The northbound diversion will be via Vicarage Road, Dartford Road, Old Bexley Lane, the A2 and Bourne Road. The southbound diversion will be via Bourne Road, the A2, Old Bexley Lane, Dartford Road and Vicarage Road. The road will re-open to southbound traffic only on 10 May. Northbound traffic will continue to be diverted until the work finishes at the end of June 2016.
- Bus routes will be diverted. For more information www.bexley.gov.uk/bexleyhighstreetbridgep2
- Pedestrian access is via a temporary footbridge.

What help can businesses get?

UK legislation currently enables them to businesses who feel they have been adversely affect by the works the chance to apply for a business rate rebate.

To claim a business rate rebate businesses please approach the Valuation Office, not the London Borough of Bexley.

The contact details for the local valuation office for businesses in Bexley Village are - Valuation Office Agency, Business rate enquiries, Unicorn House, 28 Elmfield Road, Bromley BR1 1LR. Email: ratinglondon@voa.gsi.gov.uk
Phone: 03000 501501 Fax: 03000 506631

Timetable of works

22 February until 10 May (Phase 2)

The deck of the old bridge will be demolished and the original foundations excavated. The foundations for the new bridge will be built and piled to a depth of 20 metres. A large Thames Water sewer pipe will need to be diverted to enable construction.

When the remaining part of the old bridge was demolished an additional major 30 inch water main was exposed. This main was not situated within the old bridge structure and it was therefore not part of the planned works. Several of the holding down bolts on it had rusted away. If these bolts are not replaced the main could have ruptured at any point, potentially flooding the village.

Most of the new bridge deck will then be put in place and lighting installed. Some utility services will be diverted.

10 May– End of June 2016 (Phase 3)

The final parts of the new bridge will be installed. The remaining utilities will be diverted back. Surfacing, lighting and parapet work will be completed including brick cladding.

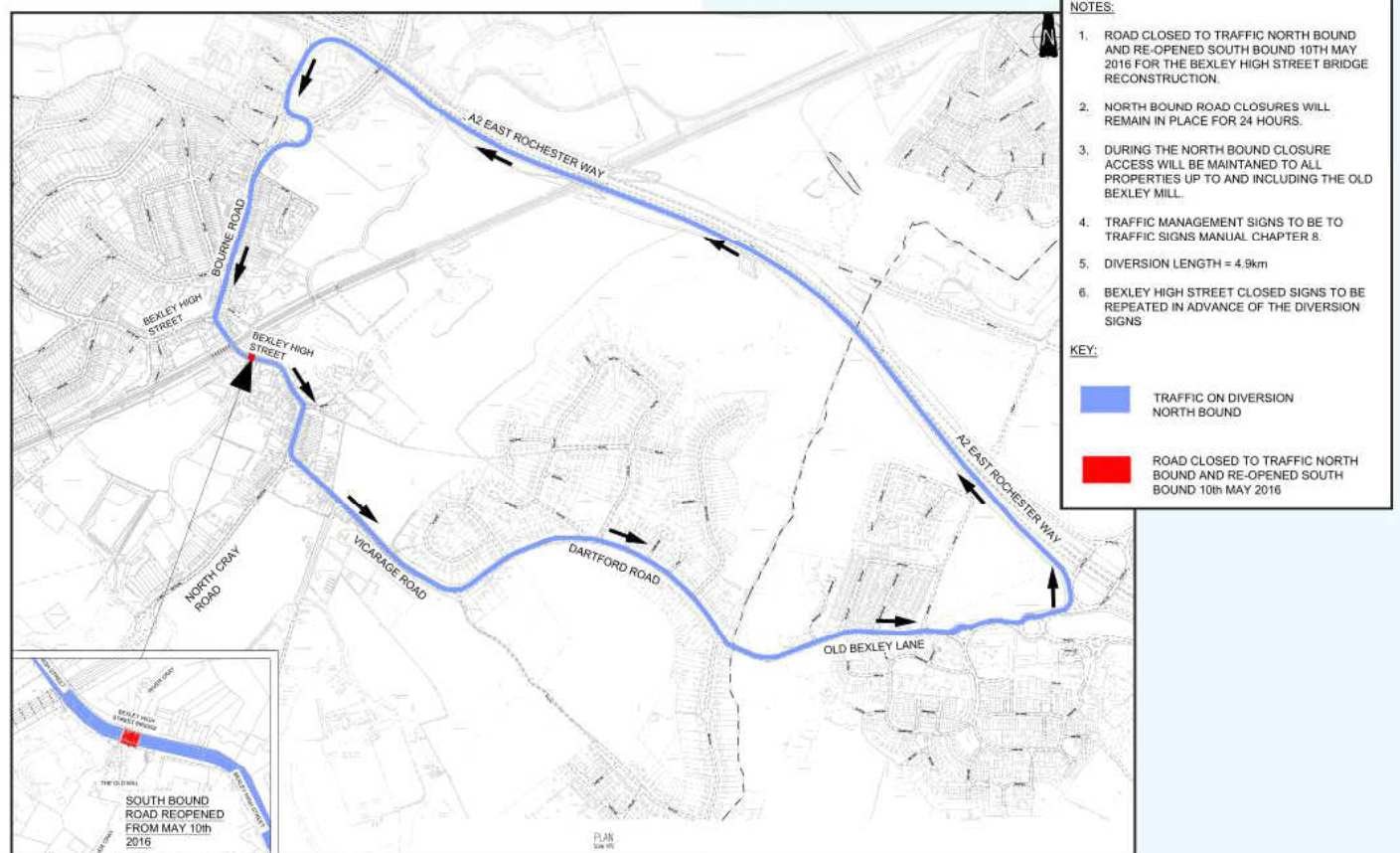

If you would like the information in this document in a different format, please call 020 8303 7777 and ask for Communications/Graphics. The reference to quote is: 606390/04.16

